



Lightcliffe Road, Palmers Green, London, N13  
Offers In Excess Of £585,000 Freehold

**Anthony Webb**  
ESTATE AGENTS

# Lightcliffe Road, Palmers Green, London, N13

A well presented, chain free, three bedroom terraced family home. The property is sold with an on-street separate garage with the potential for a parking space. Internally, the house comprises of a generously sized open-plan through lounge, with double glazed bay windows and doors to the kitchen/diner in the rear extension.

The house benefits from a spacious hallway and first floor landing, with the potential for a loft conversion (STPP). There are two good size double bedrooms and a single bedroom, as well as a family bathroom and rear garden. Offering 1,300sq.ft, the house has a bright and spacious feel throughout.

The property falls within a range of good School catchment areas such as Hazelwood Primary and St Monica's Primary. Located a short walk from Palmers Green BR station (Moorgate), good bus links to Southgate underground station as well as Hazelwood Recreational Ground and Broomfield Park being just a short walk away.

Council Tax band E

- Three bedrooms
- On street garage
- In need of modernisation
- Chain free
- Rear extended kitchen diner
- Close to train station
- Paved rear garden
- Good school catchments





Lightcliffe Road  
 Palmers Green  
 London  
 N13 5PX

Tenure: Freehold  
 Gross Internal Area: sq ft



Energy Efficiency Rating		Current	Potential
Very energy efficient - lower running costs			
(92 plus) A			78
(81-91) B			
(69-80) C			
(55-68) D		52	
(39-54) E			
(21-38) F			
(1-20) G			
Not energy efficient - higher running costs			
<b>England &amp; Wales</b> EU Directive 2002/91/EC			
Environmental Impact (CO <sub>2</sub> ) Rating		Current	Potential
Very environmentally friendly - lower CO <sub>2</sub> emissions			
(92 plus) A			
(81-91) B			
(69-80) C			
(55-68) D			
(39-54) E			
(21-38) F			
(1-20) G			
Not environmentally friendly - higher CO <sub>2</sub> emissions			
<b>England &amp; Wales</b> EU Directive 2002/91/EC			

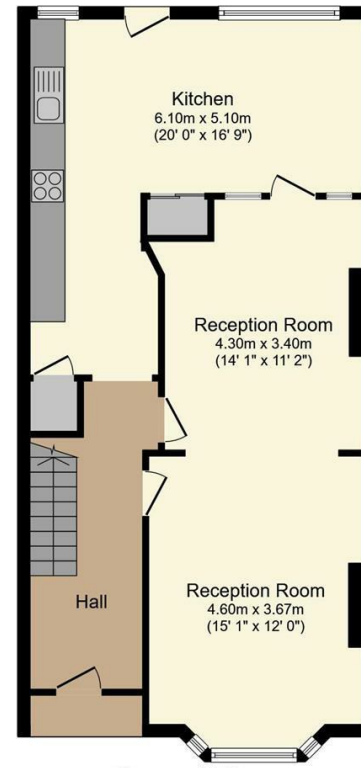

Ground Floor

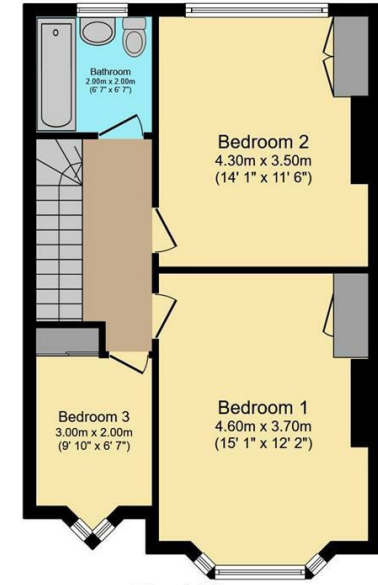

First Floor

Total floor area 120.8 sq.m. (1,300 sq.ft.) approx

This floor plan is for illustrative purposes only. It is not drawn to scale. Any measurements, floor areas (including any total floor area), openings and orientation are approximate. No details are guaranteed, they cannot be relied upon for any purpose and they do not form part of any agreement. No liability is taken for any error, omission or misstatement. A party must rely upon its own inspection(s).

Property particulars as supplied by Anthony Webb Estate Agents are set out as a general outline in accordance with the Property Misdescriptions Act (1991) only for the guidance of intending purchasers of lessees, and do not constitute any part of an offer or contract. Details are given without any responsibility, and any intending purchasers, lessees or third parties should not rely on them as inspection or otherwise as to the correctness of each of them. We have not carried out a structural survey and the services, appliances and specific fittings have not been tested. All photographs, measurements, floor plans and distances referred to are given as a guide only and should not be relied upon for the purchase of carpets or any other fixtures statements or representations of fact, but must satisfy themselves by or of fittings, gardens, roof terraces, balconies and communal gardens as well as tenure and lease details cannot have their accuracy guaranteed for intending purchasers. Lease details, service ground rent (where applicable) are given as a guide only and should be checked and confirmed by your solicitor prior to exchange of contracts. No person in the employment of Anthony Webb has any authority to make any representation or warranty whatever in relation to this property.

348 Green Lanes, Palmers Green, London N13 5TJ  
 020 8882 7888  
 palmersgreen@anthonywebb.co.uk  
 anthonywebb.co.uk

**Anthony Webb**  
 ESTATE AGENTS